



2020 DEMOGRAPHICS

1 Mile | 3 Miles | 5 Miles



Population

10,487 | 79,980 | 179,366



Employees

9,643 | 92,795 | 170,933



Median Household Income

\$38,119 | \$49,447 | \$49,199

RETAIL FOR SALE

3303 South Campbell Avenue | Springfield, Missouri 65807

84,252 SF on 6.95 +/- Acres | Call for Details

PROPERTY DETAILS

Adjacent to Walmart Supercenter

Prominent pylon signage

Possible outlot opportunity fronting South Campbell

Convenient multi-point ingress/egress with dedicated left turn lane

South Campbell Avenue - 41,798 VPD

West Walnut Lawn Street - 13,375

Jim Rosen, CCIM

314.785.7625

jrosen@paceproperties.com

PACEPROPERTIES.COM | 314.968.9898

1401 South Brentwood Boulevard, Suite 900 | St. Louis, Missouri 63144

The information contained herein is not warranted, although it has been obtained from the owner/landlord of the subject property or from other sources that Pace Properties, Inc. deems reliable, and is subject to change without notice. Owner/landlord and Pace Properties, Inc. make no representations as to the environmental condition of the subject property and recommend tenant's independent investigation.

Site Plan

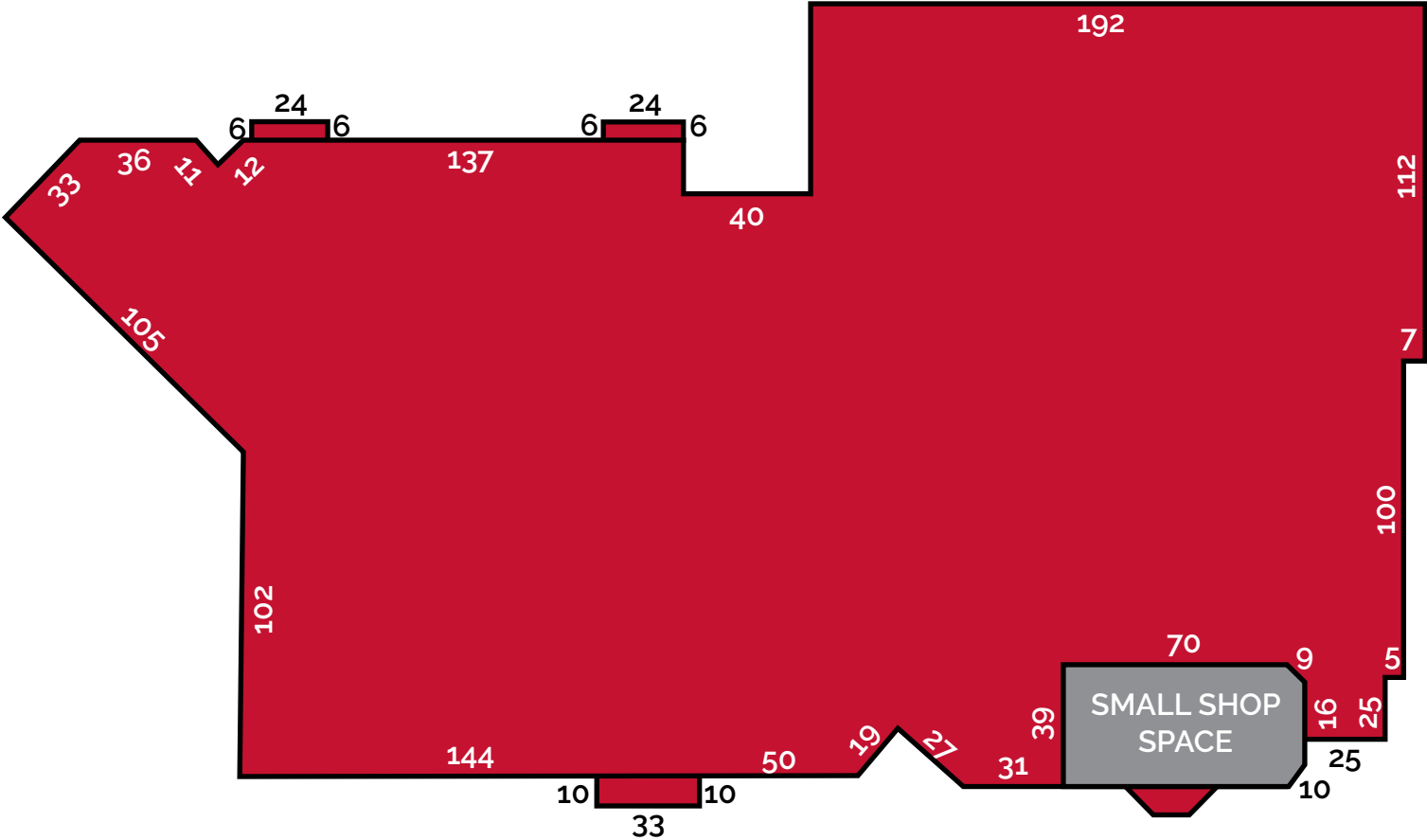

Aerial - North



PACEPROPERTIES.COM | 314.968.9898

1401 South Brentwood Boulevard, Suite 900 | St. Louis, Missouri 63144

The information contained herein is not warranted, although it has been obtained from the owner/landlord of the subject property or from other sources that Pace Properties, Inc. deems reliable, and is subject to change without notice. Owner/landlord and Pace Properties, Inc. make no representations as to the environmental condition of the subject property and recommend tenant's independent investigation.

Aerial - South



[PACEPROPERTIES.COM](https://www.paceproperties.com) | 314.968.9898

1401 South Brentwood Boulevard, Suite 900 | St. Louis, Missouri 63144

The information contained herein is not warranted, although it has been obtained from the owner/landlord of the subject property or from other sources that Pace Properties, Inc. deems reliable, and is subject to change without notice. Owner/landlord and Pace Properties, Inc. make no representations as to the environmental condition of the subject property and recommend tenant's independent investigation.