

2021 DEMOGRAPHICS
 1 Mile | 3 Miles | 5 Miles

Population
 10,631 | 92,441 | 188,687

Employees
 7,791 | 32,802 | 63,091

Median Household Income
 \$58,712 | \$70,026 | \$71,450

LAND FOR LEASE

4103 Lemay Ferry Road | St. Louis, Missouri 63125
 0.7 Acres | \$65,000/Year, NNN

PROPERTY DETAILS

- Excellent population density
- Great exposure from Lindbergh Blvd & Lemay Ferry Rd
- Ample parking
- Heavy daytime population density
- Lindbergh Boulevard - 27,694 VPD | Lemay Ferry Road - 19,687 VPD

Evan Barnett
 314.785.7678
 ebarnett@paceproperties.com

Patrick Willett
 314.785.7631
 pwillett@paceproperties.com

The information contained herein is not warranted, although it has been obtained from the owner/landlord of the subject property or from other sources that Pace Properties, Inc. deems reliable, and is subject to change without notice. Owner/landlord and Pace Properties, Inc. make no representations as to the environmental condition of the subject property and recommend tenant's independent investigation.

Site Plan

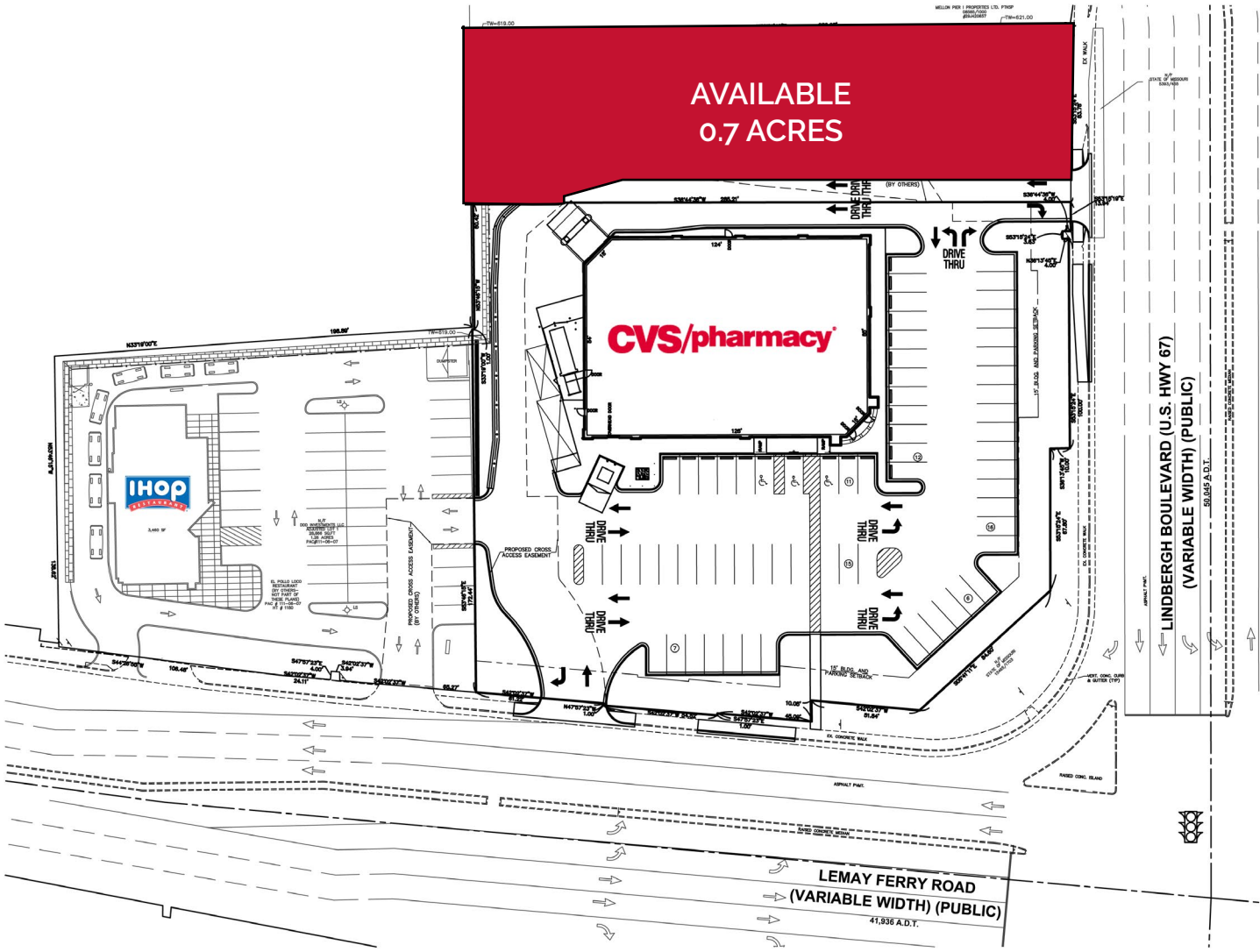

The information contained herein is not warranted, although it has been obtained from the owner/landlord of the subject property or from other sources that Pace Properties, Inc. deems reliable, and is subject to change without notice. Owner/landlord and Pace Properties, Inc. make no representations as to the environmental condition of the subject property and recommend tenant's independent investigation.