

## 2023 DEMOGRAPHICS

1 Mile | 3 Miles | 5 Miles



### Population

3,100 | 65,278 | 236,729



### Daytime Population

7,889 | 95,331 | 302,471



### Median Household Income

\$273,007 | \$153,237 | \$117,361

# FOR LEASE

9740 Clayton Road | Ladue, Missouri 63124

2,300 SF | Lease Rate: \$29.50/SF, NNN | Triple Nets: \$8.40/SF

## PROPERTY DETAILS

Excellent opportunity in highly sought after sub-market

Outstanding visibility along Clayton Road

Strong demographics

Clayton Road - 14,950 VPD

### John Shuff

314.785.7630

jshuff@paceproperties.com

### Mark Dorsey

314.785.7623

mark.dorsey@avisonyoung.com

PACEPROPERTIES.COM | 314.968.9898

1401 South Brentwood Boulevard, Suite 900 | St. Louis, Missouri 63144

The information contained herein is not warranted, although it has been obtained from the owner/landlord of the subject property or from other sources that Pace Properties, Inc. deems reliable, and is subject to change without notice. Owner/landlord and Pace Properties, Inc. make no representations as to the environmental condition of the subject property and recommend tenant's independent investigation.

# Floor Plan

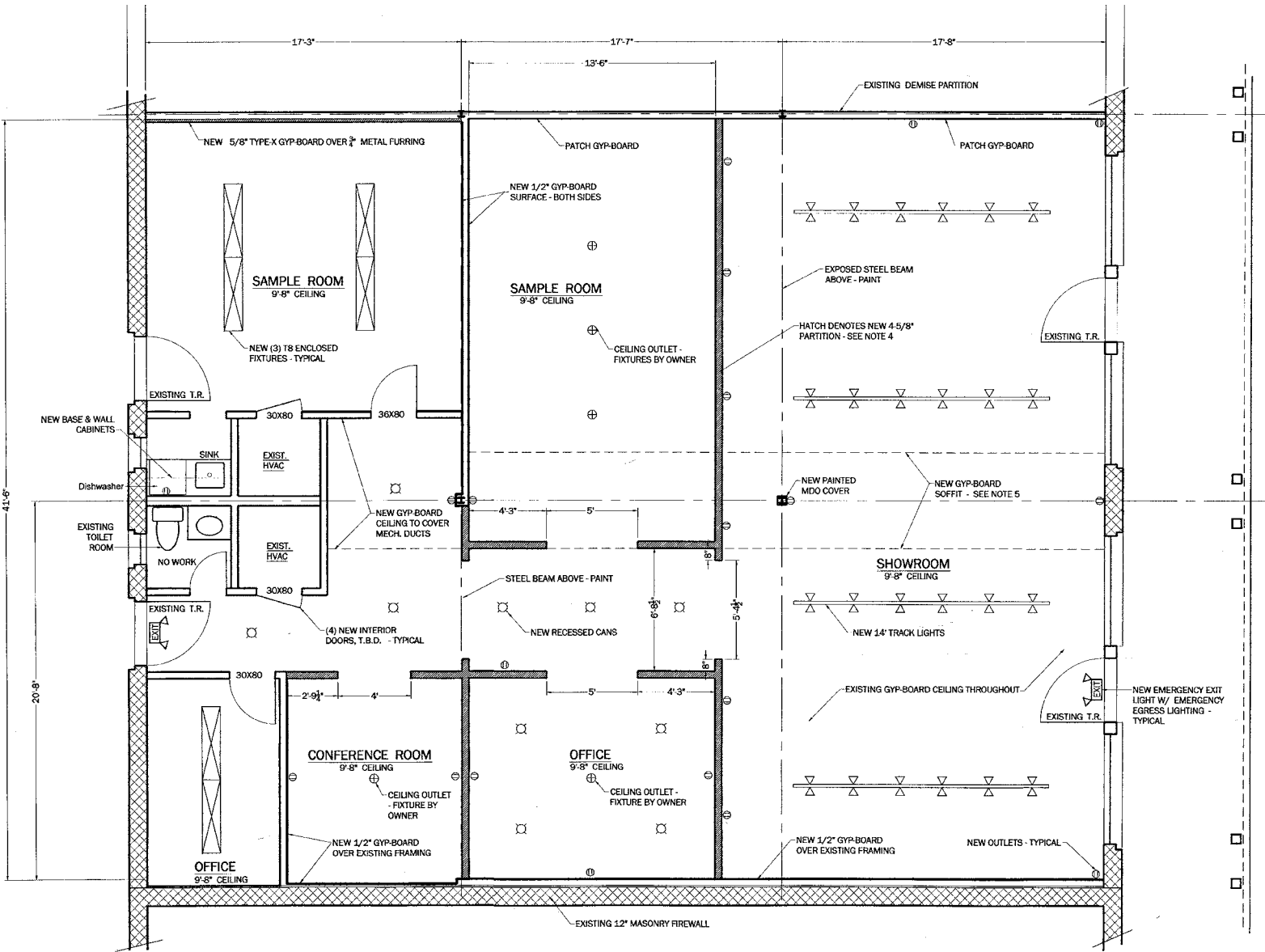

**FLOOR PLAN**  $\frac{1}{4}'' = 1'$   
 GROSS TENANT AREA = 2300 S.F. ±

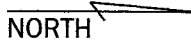

The information contained herein is not warranted, although it has been obtained from the owner/landlord of the subject property or from other sources that Pace Properties, Inc. deems reliable, and is subject to change without notice. Owner/landlord and Pace Properties, Inc. make no representations as to the environmental condition of the subject property and recommend tenant's independent investigation.