

## 2023 DEMOGRAPHICS

1 Mile | 3 Miles | 5 Miles



### Population

7,246 | 70,711 | 146,148



### Daytime Population

7,491 | 40,442 | 111,842



### Median Household Income

\$125,931 | \$136,004 | \$137,562

## RETAIL FOR LEASE

Maple Tree Center | Clarkson Road & Clayton Road | Ellisville, Missouri 63011

1,600 - 2,640 SF | Call for Details

Triple Nets: Space #3 - \$4.72/SF, Space #10 - \$5.56/SF (2024 estimates)

### PROPERTY DETAILS

Tremendous visibility from Clarkson Road & Clayton Road  
Second-generation restaurant space with outdoor patio seating  
Strong demographics  
Newly renovated facade  
Clarkson Road - 39,948 VPD | Clayton Road - 18,185 VPD

**Kate Grewe**

314.785.7662

[kgrewe@paceproperties.com](mailto:kgrewe@paceproperties.com)



**Click or scan to view  
virtual tour!**

[PACEPROPERTIES.COM](https://www.paceproperties.com) | 314.968.9898

1401 South Brentwood Boulevard, Suite 900 | St. Louis, Missouri 63144

The information contained herein is not warranted, although it has been obtained from the owner/landlord of the subject property or from other sources that Pace Properties, Inc. deems reliable, and is subject to change without notice. Owner/landlord and Pace Properties, Inc. make no representations as to the environmental condition of the subject property and recommend tenant's independent investigation.



# Site Plan

Space	Status	SF
1	Dairy Queen	2,400
2	Turner & Pooch	1,200
3	AVAILABLE	2,640
4	F45	2,640
5	Ace Hardware	14,720
6	Flanagan Paint & Supply	4,200
7	Salon Trilogy	1,200
8	Advanced Training & Rehab	2,700
9	Savers	34,848
10	AVAILABLE	1,600
11	T&J Nails	800
12	Domino's Pizza	1,600
13	Pretzel Pretzel	800
14	Great Clips	800
15	Bank of America	3,674
<b>Total GLA:</b>		<b>69,748</b>

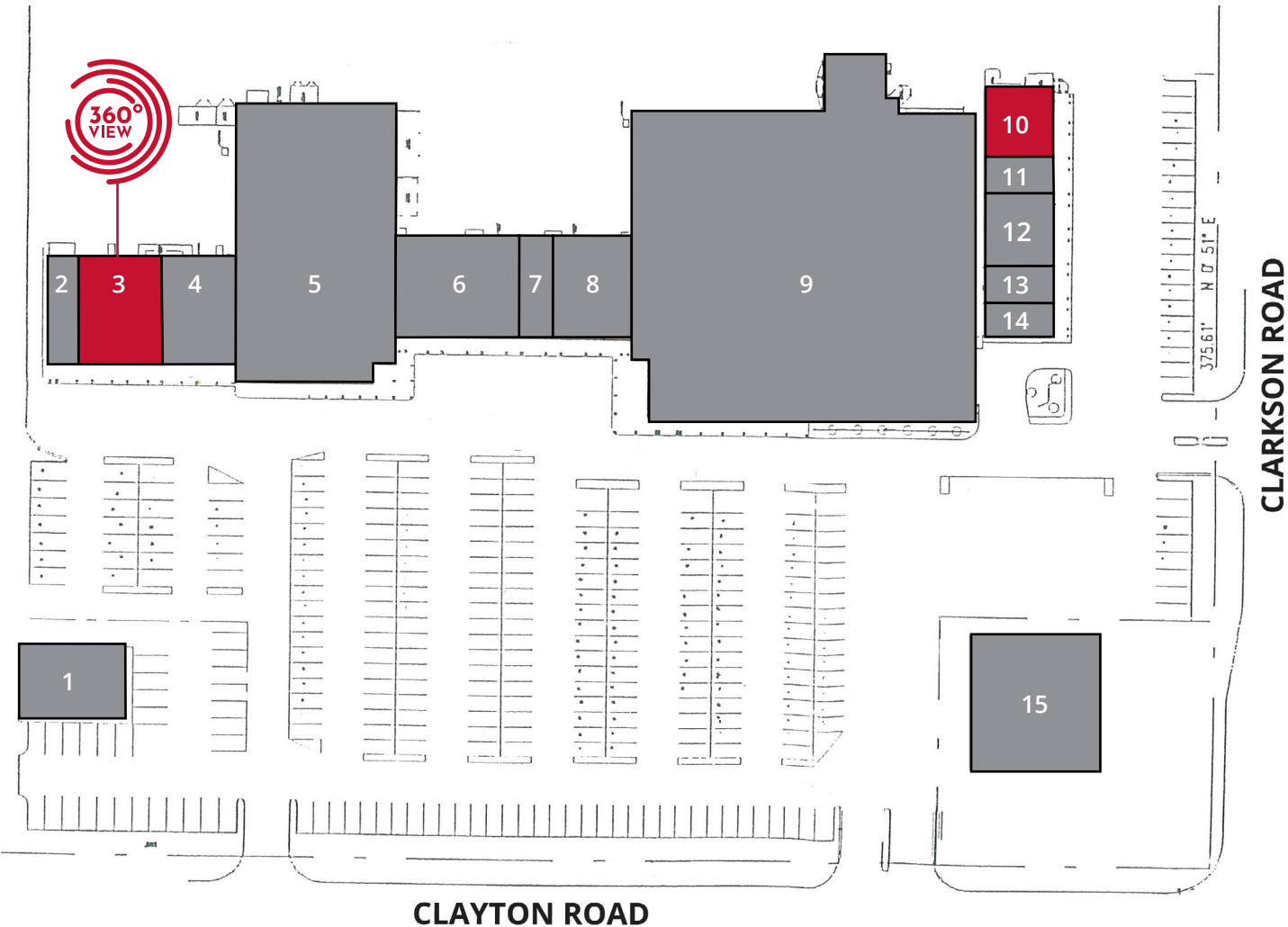

The information contained herein is not warranted, although it has been obtained from the owner/landlord of the subject property or from other sources that Pace Properties, Inc. deems reliable, and is subject to change without notice. Owner/landlord and Pace Properties, Inc. make no representations as to the environmental condition of the subject property and recommend tenant's independent investigation.

