

2023 DEMOGRAPHICS

1 Mile | 3 Miles | 5 Miles



Population

11,907 | 87,629 | 173,797



Daytime Population

6,424 | 47,574 | 100,948



Median Household Income

\$75,229 | \$79,672 | \$73,275

RETAIL FOR LEASE

3125 North Highway 67 | Florissant, Missouri 63033

2,828 SF | Lease Rate: \$42.00/SF, NNN

PROPERTY DETAILS

High-profile endcap facing N. Hwy 67 (Lindbergh)

Two-tenant building with Aspen Dental

Located at signalized hard corner

Strong food synergy with Chick-Fil-A, McDonalds, Starbucks, etc.

Ample Parking

Mike Sweargin

314.785.7635

msweargin@paceproperties.com

Patrick Willett

314.785.7631

pwillett@paceproperties.com

PACEPROPERTIES.COM | 314.968.9898

1401 South Brentwood Boulevard, Suite 900 | St. Louis, Missouri 63144

The information contained herein is not warranted, although it has been obtained from the owner/landlord of the subject property or from other sources that Pace Properties, Inc. deems reliable, and is subject to change without notice. Owner/landlord and Pace Properties, Inc. make no representations as to the environmental condition of the subject property and recommend tenant's independent investigation.

Trade Area Aerial

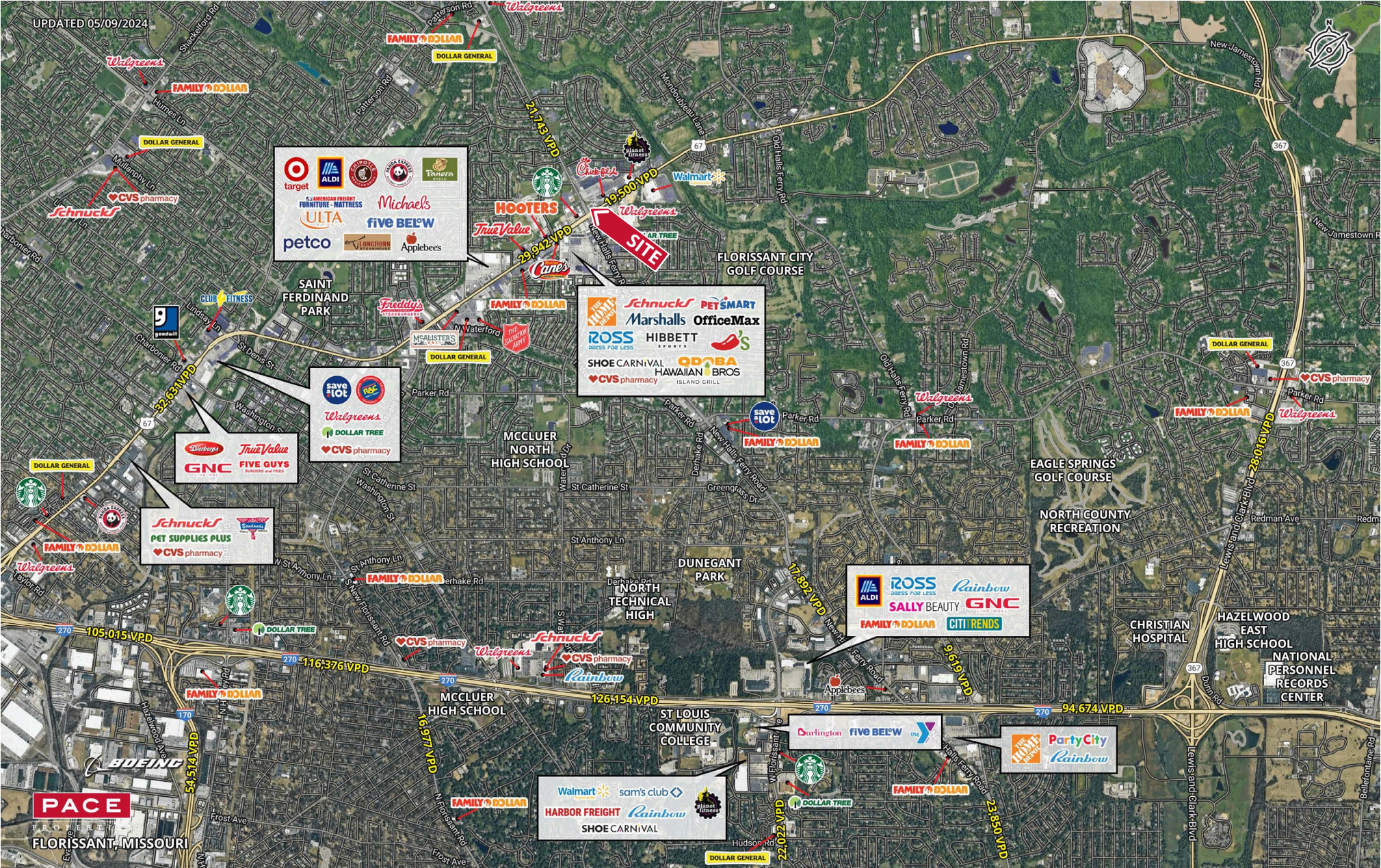



Site Plan

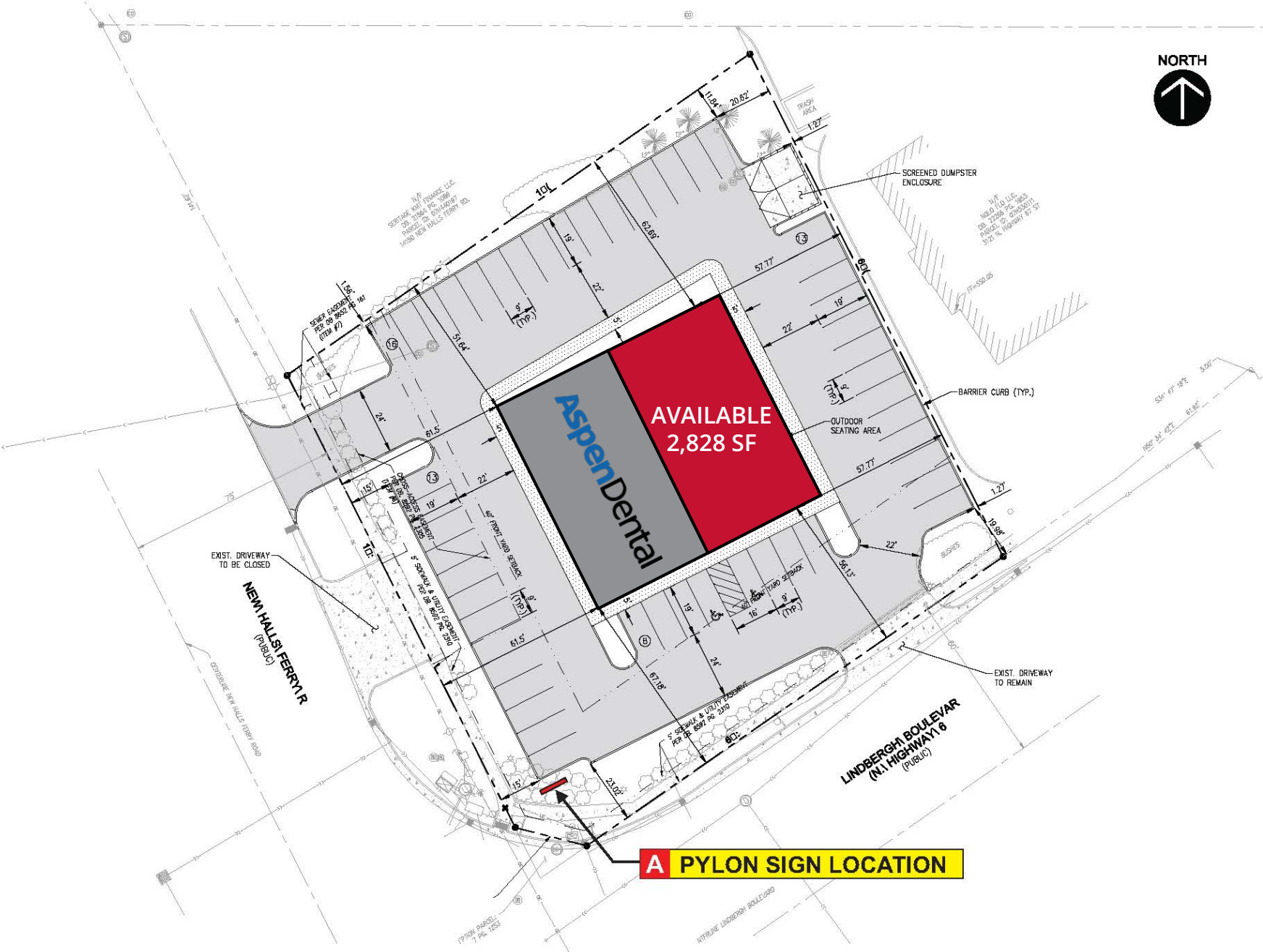

The information contained herein is not warranted, although it has been obtained from the owner/landlord of the subject property or from other sources that Pace Properties, Inc. deems reliable, and is subject to change without notice. Owner/landlord and Pace Properties, Inc. make no representations as to the environmental condition of the subject property and recommend tenant's independent investigation.